



LLD1020 Leak Detector

Environmental Systems
& Equipment Service

Liquid Leak Detection that is simply:
Rugged, Reliable, Easy and Economical

- Rugged NEMA 4X enclosure
- Rugged Capacitance sensor
- Reliable bright LED indicators
- Reliable piezo electronic horn
- Easy to operate
- Easy to install
- Economical long life sensor
- Economical cost of operation



LLD1020 Alarm Panel

The ES2 Model LLD1020 Liquid Leak Detector is designed and built for years of dependable, low cost monitoring of multiple locations.

On the outside the LLD1020 alarm panel is a rugged NEMA 4X, PVC enclosure with wall mounting kit. Super bright, energy saving LED indicator lights are guaranteed to last for over 100,000 hours, that's 11 years of continuous operation. Push buttons are large, bright, easy to see and to push, and the piezo annunciator horn produces a piercing 90 decibel alert that can be heard over noisy machinery.

On the inside the LLD1020 is designed and built for simple, reliable operation. Control circuits monitor each sensor continuously to ensure a fast response to a leak. A dry contact output is provided for remote signaling of a leak. Hook up to any voltage between 100 and 240 Vac and the auto-sensing, thermal protected power supply does the rest, drawing only 6 watts.

The Capacitance sensor used by the LLD1020 is heavy duty IP65 rated for submersion in water and includes a 25ft cable (optional extension cables available). The sensitive non-contact proximity switch will detect as little as 1/32 inch of liquid without false alarms. An LED status indicator lights when the sensor is functional and not in an alarm state. Sensor is factory calibrated, with adjustable sensing distance to allow for field adjustment if necessary.



Sensor



Cable

**Environmental Systems &
Equipment Service, Inc.**

6912 Old Easton Road, P.O. Box 507
Pipersville, PA 18947

Phone: 877-766-2ES2 (2372) toll free

Fax: 215-766-7783

www.ES2inc.net



LLD1020 Leak Detector

Environmental Systems
& Equipment Service

Specifications:

Alarm Panel

Enclosure	PVC molded, foam gasket, SS screws, UL, NEMA 4,4X, 6P rating
Dimensions	8"wide x 8" high x 4" deep
Indicator lights	NEMA 4X, 22mm, bright LED, 100,000 hour, efficient, cool operation
Push Buttons	NEMA 4X, 22mm, heavy duty, safety yellow
Annunciator Horn	NEMA 4X, molded, solid state piezo electric, 95 decibels @ 2ft
Power cord	Length 6ft, conductor 16awg, 120v plug
Power requirements	100-240 Vac, 50-60hz, 1-phase, 6 watts
Alarm output	Dry (unpowered) contact, 8 amp, selectable N.O. or N.C.
Temperature range	0° F to 130° F

Sensor

Materials	Chemical resistant PVC, IP67 immersable, UL rating, mount CPVC
Cable	PVC sealed with plug end, standard length 25ft (optional extension cables)
Dimensions	Overall including mount 4" x 4" x 1.63"
Mounting	304 Stainless Steel - free standing or bolt down
Technology	Capacitive proximity - maximum distance sensitivity .39"
Power	24Vdc, 2ma supplied from LLD1020 alarm panel
Output	Fail-safe NPN: on during normal operation - off in alarm state
Indication	Sensor LED illuminated = normal condition, Off = liquid leak condition
Temperature Range	13° F to 122° F

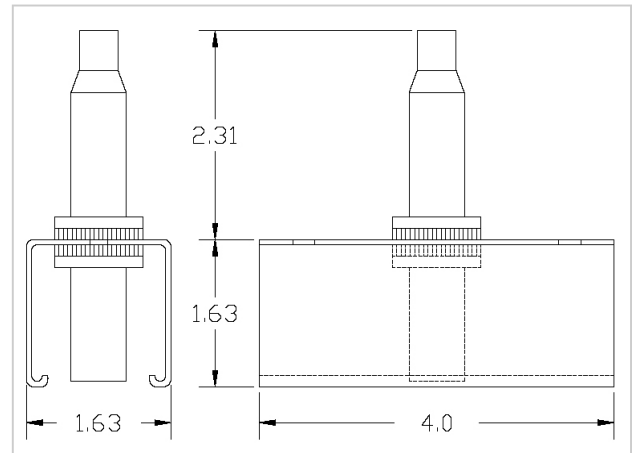
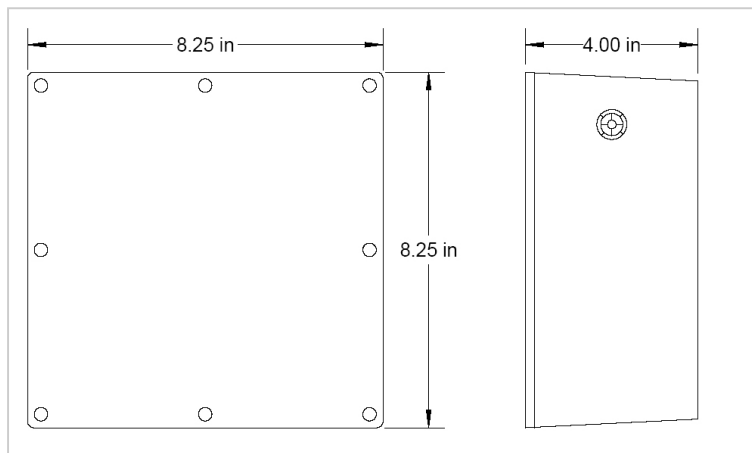

Applications:

- Monitor chemical storage tank secondary containment
- Monitor piping secondary containment
- Monitor chemical storage room floor
- Monitor for water leaks in flood prone areas
- Monitor for oil leaks on machinery
- Monitor for process leaks
- Monitor for HVAC condensate leaks

LLD1020 Options:

- Custom programming and controls
- Custom enclosures
- Battery Back-up
- Solar power supply
- Radio or cell phone alarm transmission

Call today for a price on
the LLD1020 leak detector.

And don't forget:
At ES2 we install the products
we sell. For a quality
installation call ES2.

**Environmental Systems &
Equipment Service, Inc.**

6912 Old Easton Road, P.O. Box 507
Pipersville, PA 18947

Phone: 877-766-2ES2 (2372) toll free

Fax: 215-766-7783

www.ES2inc.net